

- NOTE:
- 1. ELECTRICAL CHARACTERISTICS
  - 1-1. CONTACT RESISTANCE, 80 MILLIOHMS MAX.
  - 1-2. INSULATION RESISTANCE, 1,000 Megohms MIN.
  - 1-3. DIELECTRIC WITHSTANDING VOLTAGE, 500V AC MIN FOR 1 MINUTE.
  - 2-2. DURABILITY, 5,000 CYCLES
  - 2-3. PRODUCT COMPLETED WITH HSF

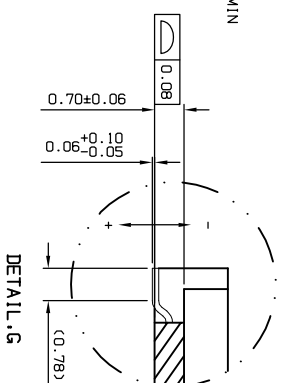
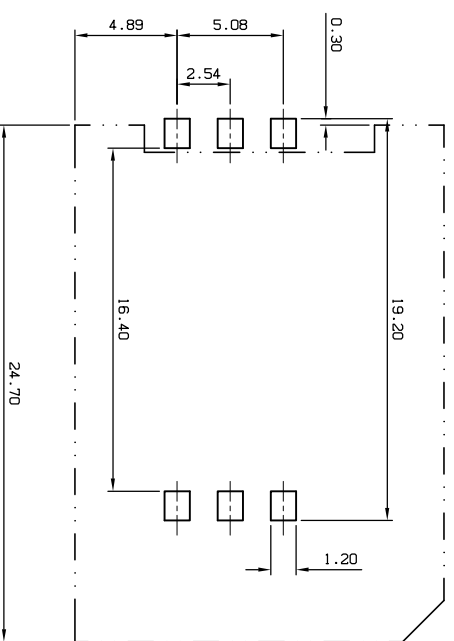

RECOMMENDED PC BOARD LAYOUT  
TOLERANCE, ±0.05(TOP VIEW)

TABLE B.

PIN NO.	PIN NAME
C1	Supply Voltage Vcc
C2	Reset (RST)
C3	Clock(CLK)
C4	N/A
C5	Ground
C6	Programming Voltage Vpp
C7	I/O
C8	N/A

4	LOCK	2	STAINLESS STEEL	T <sub>h</sub> PLATING
3	TERMINAL	6	COPPER ALLOY	CONTACT 10μ" Au OVER ALL.
2	SHELL	1	STAINLESS STEEL	N/A PLATING
1	DOWN HOUSING	1	THERMOPLASTIC	UL 94V-0
ND.	DESCRIPTION	QT.Y	MATERIAL	NOTE

UNLESS OTHERWISE SPECIFIED TOLERANCES

DECIMALS.	ANGLES.
X .40.5	X ±.2°
X.X .40.20	X.X ±.1°
X:XX .40.10	

深圳市精睿兴业有限公司  
SHENZHEN KRCCONN TECHNOLOGY CO., LTD

TITLE 1.8H HINGE SIM CARD CONN ASSEM.  
DWN JOHNLE PART NO. 9502-00615-01R  
CHKD KEVIN.D SCALE: 1:1 UNIT: mm  
APVD SIMON.M SIZE: A4 SHEET: 1 OF 1 REV. A

SLIDE THE SHELL

FINISH

CUSTOMER COPY

REV.	ECN NO OR DESCRIPTION	REVISED	DATE
1	PROPOSE ONLY	SIMON	07-03-12
2	MODIFY THE INSER MOLDING	SIMON	07-09-13